



20
YEARS
 100 MILLION
 THANK-YOUS



HEALTH CARE
 FOUNDATION

Annual Report 2022-2023





MESSAGE FROM OUR CEO & CHAIR

Dear Friends,

This annual report covers an exciting time for the Health Care Foundation. In 2022-2023, the Health Accord for Newfoundland and Labrador was released, with goals of a 10-year health transformation, shaped by public engagement. The Health Care Foundation is excited to be an integral part of this change. We look forward to working with the provincial government, our donors, and the health authority to make the changes we all deserve a reality.

This year, the Health Care Foundation celebrated our 20th anniversary. We reflected on this major milestone and the advancements in local healthcare, all made possible because of you, our donors. We returned to a full event schedule, raising funds for Cardiac, Mental Health, Emergency PAU, Ambulatory Care and more.

We continued to support our hospitals and health centres by investing \$3,335,843 into the best technology, equipment and comfort items. Of course, none of this would be possible without the support of donors like you. From the bottom of our hearts, we thank you for your support.

The Health Care Foundation would like to thank the General Hospital Auxiliary for its support over the past fifty years. Your energy will be missed. We also thank our outgoing Board member, Margaret Butt. We would like to welcome Mr. Craig Tucker and Mr. Ron Johnson to the Board of Directors.

Your support of the Health Care Foundation makes a tremendous impact on the way Newfoundlanders and Labradorians experience healthcare. Your donations help improve the care of patients and equip our health care professionals with the tools they need to save lives. Thank you.

Sincerely,

Ken Bennett
Board Chair

Paul Snow
President&CEO

In 2022-2023,
our donors invested
\$3,335,843
into improving
healthcare for
Newfoundlanders and
Labradorians

\$133,220
in comfort
items and
revitalized
hospital
spaces

Your
donations
make a
difference!

\$2,761,090
in vital
equipment
and
technology

\$441,533
in research
and
education

IMPROVING YOUR HOSPITALS AND HEALTH CENTRES

The Health Care Foundation supports a wide variety of sites and programs that provide adult healthcare, from birthing suites to palliative care, and everything in between. We support the largest provider of primary and tertiary care in Newfoundland and Labrador. Our sites see approximately one million direct patient encounters each year. The hospitals and health centres your donations support include the Health Sciences Centre, Pleasant View Towers, Dr. Walter Templeman Health Care Centre, Caribou Memorial Veterans Pavilion, Dr. L.A. Miller Centre, Nuclear and Molecular Medicine Facility, Dialysis, LeMarchant Houses, and the Recovery Centre.



20
YEARS
100 MILLION
THANK-YOUS



HEALTH CARE
FOUNDATION



The Health Care Foundation has raised over \$100,000,000 in funds to improve the delivery of care in adult hospitals and healthcare facilities for patients across Newfoundland and Labrador.

Your donations have transformed departments like cardiac, dialysis, rehabilitation, ophthalmology, and diagnostic imaging. You've funded the purchase of major technology and equipment, including the 3T MRI, integrated operating rooms, cath labs, echocardiograms, c-arms and so much more.

Thank you!



Since installation in 2018, the 3T MRI has performed over 30,000 vital diagnostic scans. This 3T MRI helps doctors investigate and diagnose conditions with improved accuracy, patient safety and comfort.

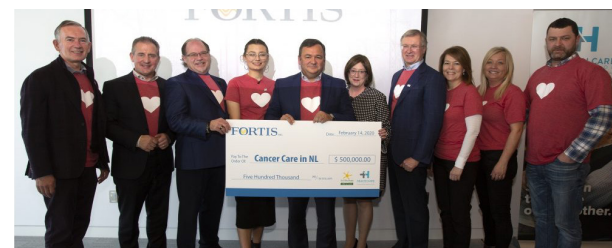
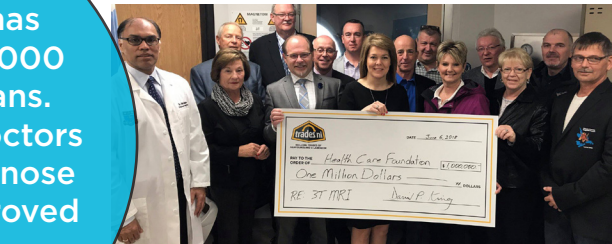
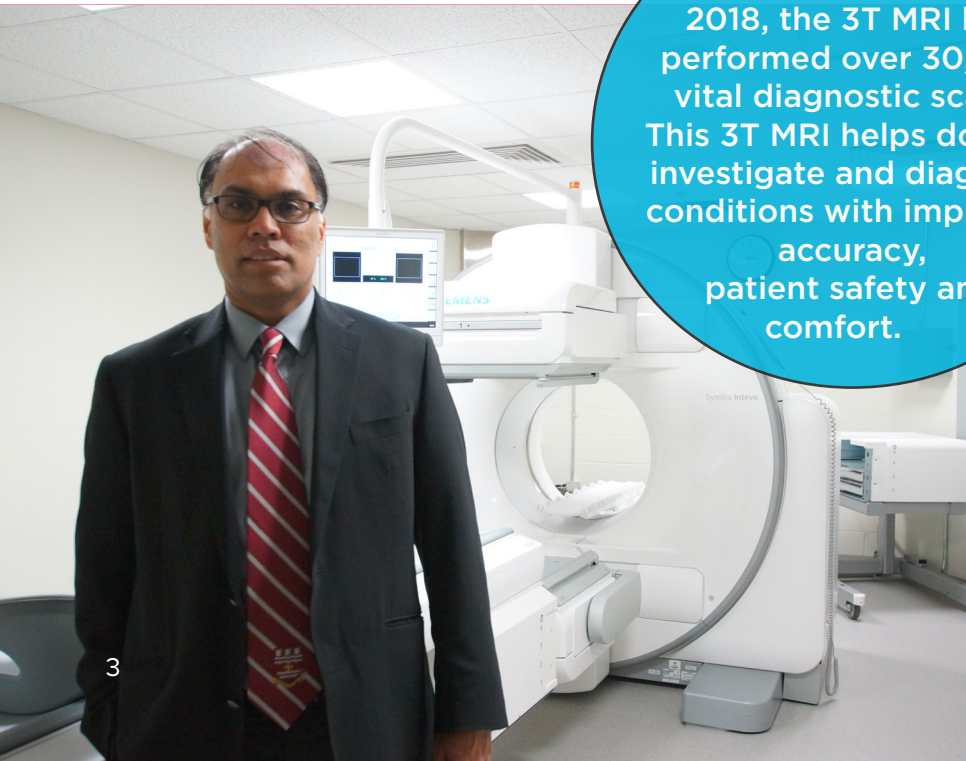

Your donations enhance surgical care in Newfoundland and Labrador. Significant progress has been made to transform 17 traditional operating rooms into state-of-the-art integrated operating suites. To date, 12 operating suites have been transformed.



1 in 3 people in our province are affected by heart disease. The Health Care Foundation is replacing our Cardiac Catheterization Labs, and increasing capacity with a fourth lab, creating a Cardiac Catheterization Luminary Site that will reduce wait times and help save lives of cardiac patients.

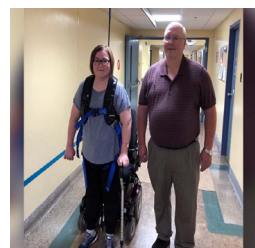

CARDIAC AND STROKE CARE

1 in 3 people living in Newfoundland and Labrador will be impacted by cardiac illness. Having quality cardiac services is crucial, and technology is always changing.

The Health Care Foundation knows that the best cardiac care and technology are critical to the well-being of Newfoundlanders and Labradorians. This year, through our donors, we funded \$2,090,000 towards our Cardiac Catheterization Labs, including the development of a fourth new Cath Lab.

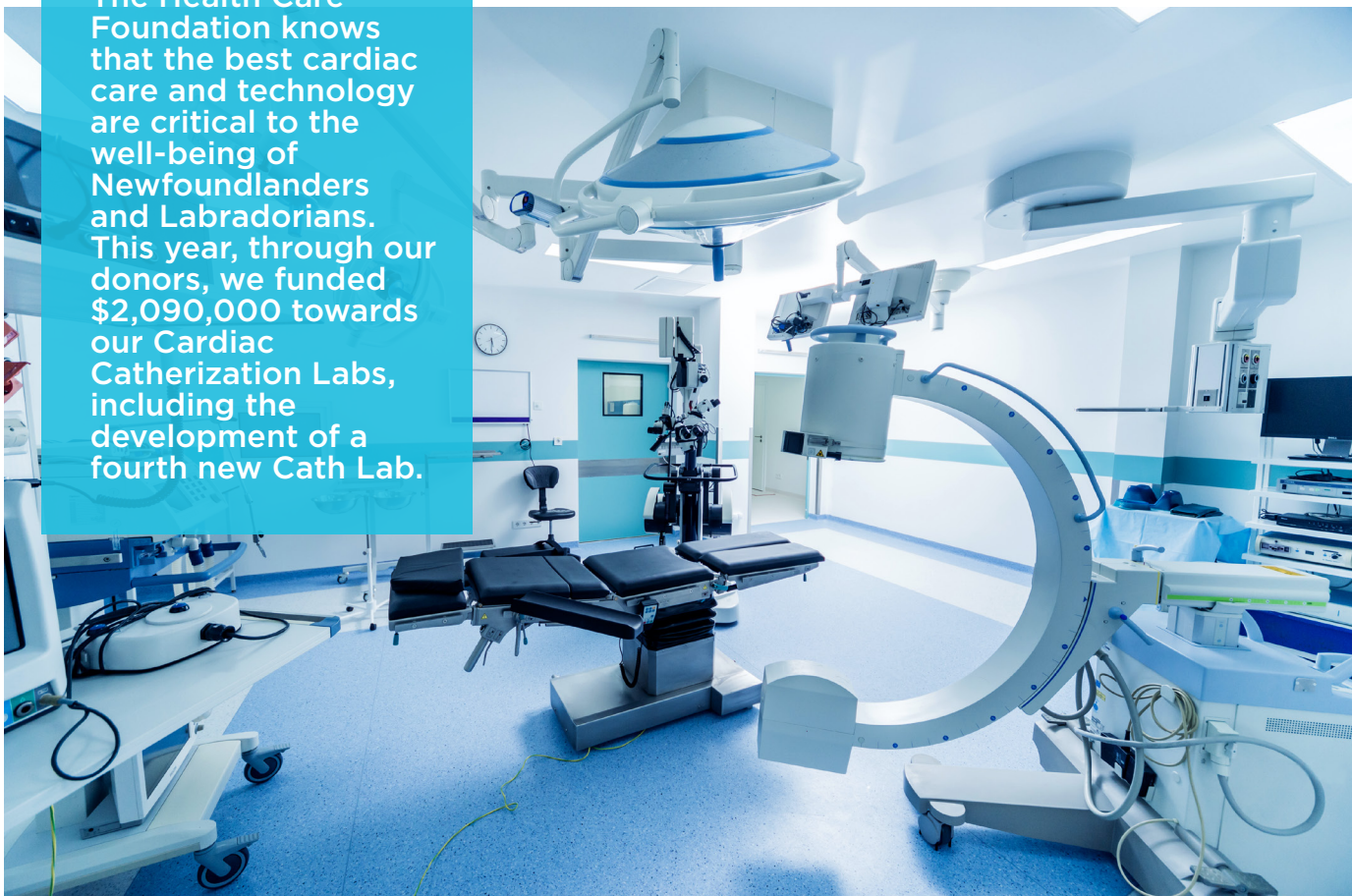

THROMBOSIS SERVICE FUND

Blood clots and bleeding can lead to severe health complications and death, but the focus on Thrombosis is relatively new. Newfoundland and Labrador is at the cutting edge of Thrombosis management and research. The Multidisciplinary Thrombosis Service at the Health Sciences Centre started in 2017, and receives about 1,500 patient referrals each year. The team is comprised of Thrombosis Physician Specialists and Thrombosis Clinical Pharmacist Specialists. Patients are assessed, managed and followed in the clinic, and subsequently, the team provides their healthcare provider with advice on how to provide the best ongoing care.

The Thrombosis Service Fund currently supports the research of two full-time post-doctoral thrombosis research fellows, and a masters student.

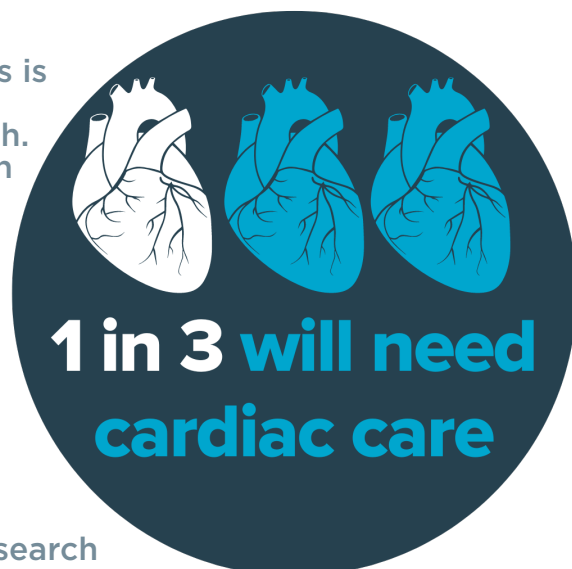

HISTORIC DONATIONS TO CARDIAC CATHERIZATION LABS

Three remarkable families, Erin and Brendan Brothers (Brothers Family Foundation), Melissa Barron and Jamie King (King Family Foundation), and Janine Woodrow and Raymond Pretty (Pretty-Woodrow Foundation), have come together to make a substantial impact on cardiac care. Here are their stories in their own words.

WHAT MADE YOU CHOOSE TO SUPPORT THE CARDIAC CATHERIZATION LABS?

Brothers Family Foundation: Cardiac care was particularly important to us, as it is a growing problem in our province and one that has affected our families directly. Being able to improve the speed and quality of care is something we're happy to be able to support.

King Family Foundation: Cardiac seems to hit everyone at some point in their life. You need the care. Our professionals are great. They need the technology, equipment and are trying to improve followup care. We don't want to lose doctors to lack of technology. Cardiovascular care is so important. We have an aging population and we need to help them.

Pretty-Woodrow Foundation: The cardiac cath labs are used by all communities in our province. People should not have to wait long to access this essential diagnostic and treatment service. We are pleased to help support the update of the cardiac cath labs at the Health Sciences Centre.

WHAT WOULD YOU TELL SOMEONE WHO IS CONSIDERING DONATING TO THE HEALTH CARE FOUNDATION?

Pretty-Woodrow Foundation: What is more important than our health? Investing in local healthcare benefits us all. The Health Care Foundation is critical to helping advance cardiac care services, along with many other health care services for the people of Newfoundland and Labrador. Going through the Health Care Foundation made it easy to directly support the cardiac care program in a coordinated way.

Brothers Family Foundation: We're happy to be able to help give back to healthcare in Newfoundland and Labrador, where we've been born and raised, and our large families on both sides live.

King Family Foundation: At some point, we are all going to need good healthcare. Imagine not having to go away, having healthcare right at your fingertips. We all deserve access to good urgent care. It's expensive stuff. The Health Care Foundation advocates to raise more money for important healthcare tools. We believe funds are being used wisely.

These three families have come together in their commitment to improving cardiac care in Newfoundland and Labrador. Thanks to their generous donations, new Cardiac Catherization Labs are being installed to help increase access to care at home.

VIRTUAL-FIRST CARDIAC CARE

Newfoundlanders and Labradorians often find ourselves traveling for important appointments. With Cardiac Care, needs are often unexpected and immediate. Residents should have equal and timely access to the best care, regardless of where they call home. This year, your Health Care Foundation raised funds for Virtual-First Cardiac Care, so the Heart Team can instantly "see" patients in emergent or critical care settings, anywhere in the province. Using specialized kits of new cardiac equipment and technology, the Heart Team will be able to listen to patients' heartbeats and assess function remotely.



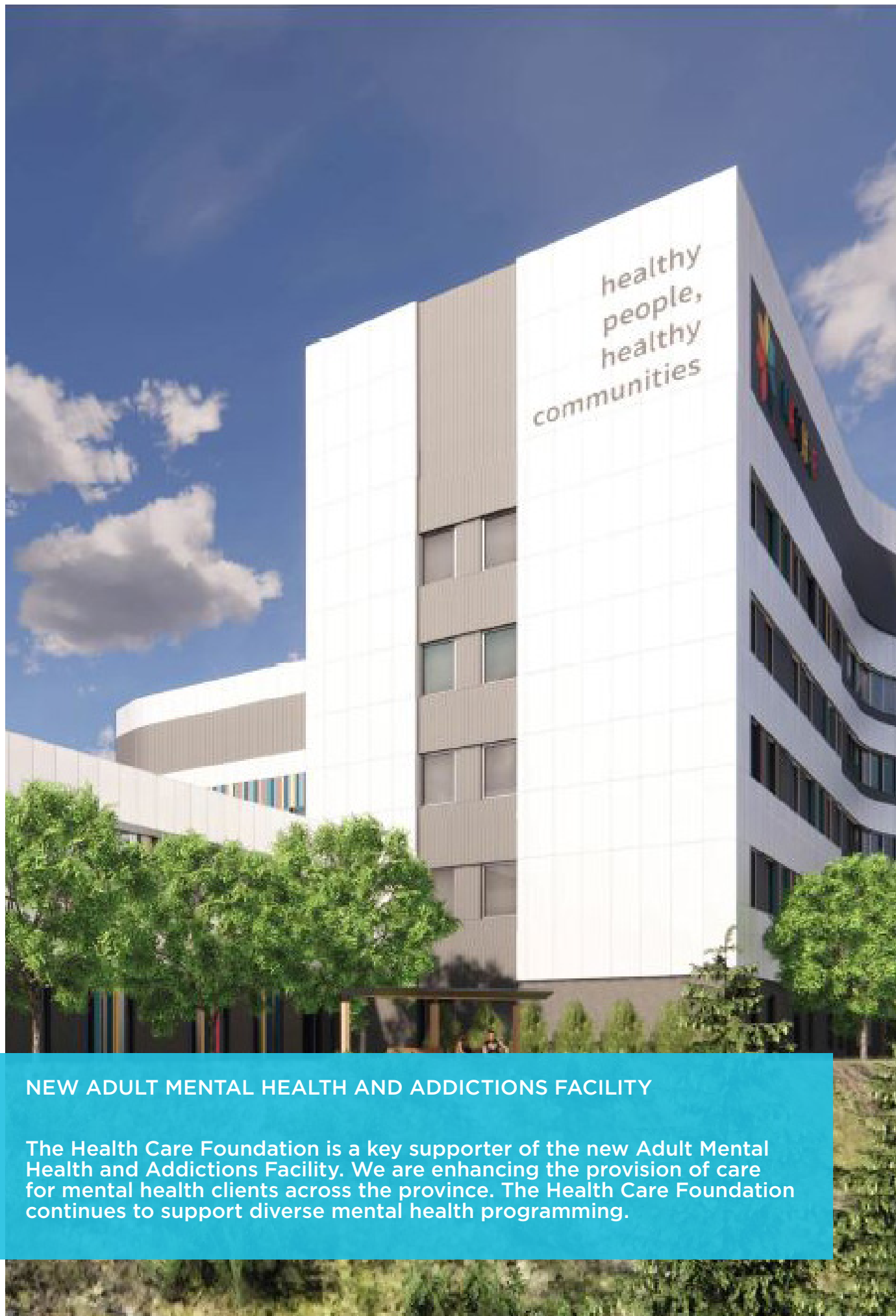

NEW ADULT MENTAL HEALTH AND ADDICTIONS FACILITY

The Health Care Foundation is a key supporter of the new Adult Mental Health and Addictions Facility. We are enhancing the provision of care for mental health clients across the province. The Health Care Foundation continues to support diverse mental health programming.

MENTAL HEALTH

MOVING LIVES FORWARD SCHOLARSHIP PROGRAM

Thanks to NAPE's multi-year commitment of \$180,000, Moving Lives Forward became a province-wide scholarship program in 2020. Each year, \$45,000 in scholarships is awarded to recipients from adult mental health and addictions programs to pursue educational opportunities. The Moving Lives Forward Scholarship Program allows participants to grow through the pursuit of personal development, skills training and advancing education.

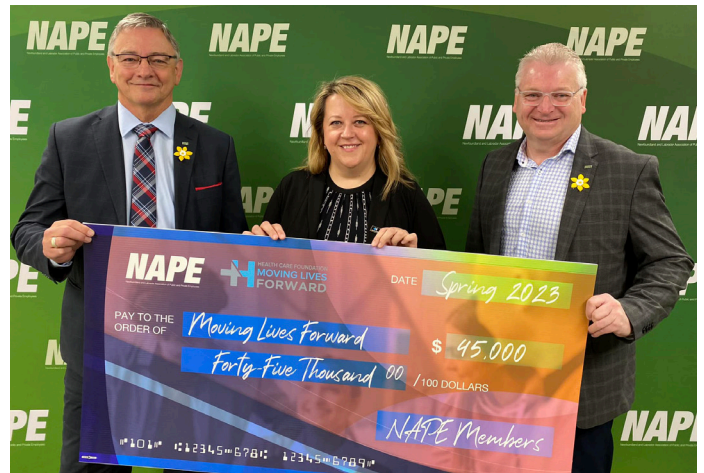

RBC FIRST RESPONDER PSYCHOLOGICAL SAFETY COLLABORATIVE

RBC continues to support mental health initiatives through donations to the Health Care Foundation. This year, RBC provided \$30,000 in funding to the Rapid Response Team and Psychological First Aid (PFA) facilitator training. The Rapid Response Team addresses the psychological safety needs of employees and physicians by providing opportunities to meet and debrief with facilitators. PFA aims to reduce stress symptoms and assist in a healthy recovery following a traumatic event, natural disaster, public health emergency, or even a personal crisis.

THERAPEUTIC GARDENING PROGRAM

The Health Care Foundation works with the Therapeutic Gardening Program under the Comfort in Care™ staff fundraising matching program to ensure the team has the supplies it needs for an enriching program for patients of Mental Health programs at the Waterford Hospital. Patients participate in seasonally driven activities, grow plants and host plant sales, which in turn, fund programming.



THE MILLER CENTRE

CUDDLE BED PROJECT

The Palliative Care Unit at the Dr. L.A. Miller Centre provides patients and their families with the best possible quality end of life care. Palliative Care staff reached out to the Health Care Foundation requesting a cuddle bed for their unit. Maintaining physical contact, being touched and experiencing intimacy with family and loved ones helps patients who are terminally ill feel supported. In palliative care, these beds can provide relief in the last moments by allowing closeness, while keeping the patient comfortable without interfering with medical equipment and care.

Our goal with the Cuddle Bed Project was to put a special, wider bed in the Palliative Care Unit of the Dr. L.A. Miller Centre. Because of your support, we were able to raise \$36,000 to purchase two cuddle beds for patients receiving end of life care and their loved ones.



ELECTROMYOGRAPHY MACHINE

Electromyography (EMG) machines help put patients suffering from muscular discomfort on the path to healing. This year, we supported the Dr. L.A. Miller Centre, Newfoundland and Labrador's main public rehabilitation hospital, with the purchase of a new EMG machine to help patients receiving rehabilitation care. The EMG supports team members who work with the patient, helping them set goals for improvement, ultimately providing people with skills and tools to attain or maintain independence.

KNOWLEDGE TRANSFER FUND

The Knowledge Transfer Fund makes it possible for healthcare providers at the Dr. L.A. Miller Centre to attend specialized and advanced training. The Miller Centre is the provincial rehabilitation site and exposure of staff to innovations in the rehabilitation sector occurs out of province. The Health Care Foundation supports the Staff Knowledge Transfer Fund: Professional Education Fund for staff, which impacts staff's ability to stay current in the field.

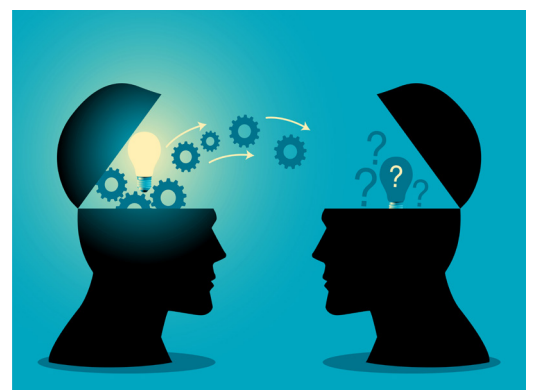

MAKING A DIFFERENCE IN OUR HOSPITALS AND HEALTH CENTRES



UPGRADING PATIENT EQUIPMENT

Each year, your donations make it possible to purchase and upgrade a variety of specialized medical tools for use in our hospitals and health centres. This year alone, your donations purchased Broda chairs, wheelchairs, recliners, medical equipment, and much more. Impacts can be seen in many facilities, including Pleasant View Towers, St. Clare's Mercy Hospital and Bell Island.

WAYFINDING

Effective signage makes our hospitals and health centres easier to navigate and more accessible for patients and their loved ones. The Health Care Foundation has made a multi-year commitment of \$900,000, using funds raised from our Health Care Foundation Home Lottery to improve wayfinding.



ARJO ELECTRIC WALKING AID

Thanks to our generous donors, we were able to purchase a new ARJO Electric Walking Aid, which was donated to 5 South B Neurosurgery.

The walking aid provides secure conditions for taking first steps, and reduces transfer risks for patients and healthcare providers when the patient is raised or lowered to sit or stand. This device is designed to help with gait training, and has easy steering so patients can easily walk straight ahead.

NURSING CARE CENTRES

Our nurses work hard. They deserve a comfortable spot to take a break between taking care of patients. This year, \$445,000 in proceeds from the Health Care Foundation Home Lottery paid for new nursing care centres for the Health Sciences Centre.





INTEGRATED OPERATING SUITES

Through a multi-year project, TradesNL has made the commitment to transform 17 Integrated Operating Suites. So far, their donations have supported the upgrading of 12 Integrated Operating Rooms - with five more to go. This year, \$144,858 of donor funds supported Integrated Operating Suites at St. Clare's Mercy Hospital. These next generation operating suites have all surgical equipment coming from ceiling booms, reducing the amount of staff required to perform each surgery, reducing risks of infection, improving efficiencies, staff and patient safety, and impacting outcomes in a more technologically advanced environment.

INNOVATION

Tech NL leads the growth of the medtech ecosystem in Newfoundland and Labrador. Tech NL's mission is to accelerate the growth of the health innovation sector, with a vision to help the province become the testbed for medical technology in North America by supporting medical innovators and entrepreneurs. The Health Care Foundation is pleased to support this growth by providing \$87,000 in funding.

The Health Care Foundation is a proud partner of the Innovation Accelerator Centre, providing multi-year support.



CENTRE FOR TRANSLATIONAL GENOMICS

The Health Care Foundation supports the Centre for Translational Genomics, a joint initiative between Memorial University and NLHS, located in MUN Medical School. The centre will test samples locally, instead of shipping outside of the province, allowing faster turnaround times for researchers, clinicians and patients, and better integration between research and clinical services. The Health Care Foundation contributed \$50,000 to this important cause, concluding our two-year, \$100,000 commitment to the Centre for Translational Genomics.

OUR PROGRAMS

The Health Care Foundation makes a direct difference in our hospitals and health centres by making spaces more comfortable and homelike for patients and their families while ensuring healthcare providers have the training they need to do the best job providing essential supports.



EASTERN HEALTH STAFF SCHOLARSHIPS

Each year, our donors provide \$10,000 in scholarships to staff in our hospitals, so they can keep up to date with advances in their field, and in turn, provide optimal care for our patients.



CANADIAN NURSING ASSOCIATION GRANTS

Nurses are the heart of our hospitals and patient-centred care. Each year, thanks to Johnson, nurses can apply to have their certification and re-certification covered by the Health Care Foundation.

The program is available to staff in all departments. This year, the Canadian Nursing Association (CNA) Grants program awarded 25 grants, totaling \$15,000.



PEACEFUL PORTS™

Our Peaceful Ports™ program provides soothing and comfortable spaces for our patients and their families in our hospitals. Surroundings have a major impact on our well-being and mental health.

Our Peaceful Ports™ spaces feature soft lighting, fireplaces, artwork, wifi, comfortable seating, televisions and greenery to create a homelike environment.



COMFORT IN CARE™

To celebrate the Health Care Foundation's 20th Anniversary, we increased the Comfort in Care™ Grant funding to \$100,000, resulting in 82 grants awarded. The Comfort in Care™ program began in 2005, as a way for frontline healthcare workers to identify ways to make patients and their families more comfortable with items outside of the normal hospital budget. Since then, we have awarded over \$900,000 in grants for items that make a powerful difference in the healthcare experience for patients and their families.



ELEGANZA

The Health Care Foundation welcomed guests back to Eleganza: All that Jazz on November 26 at the Delta, presented by Johnson. Eleganza celebrated the roaring 20s; a nod to the Health Care Foundation's milestone anniversary. Guests stepped into a 1920s speakeasy for an evening of delicious food, dueling pianos, a barbershop chorus and vintage cars, hosted by Sheila Williams.

All funds raised at Eleganza supported the newly developing Emergency Psychiatric Assessment Unit. Housing the Psychiatric Assessment Unit within the Health Sciences Emergency Department will revolutionize how both physical and mental healthcare needs are met. Clients with mental health needs who present at the emergency centre will be treated in real time, eliminating transfers to outside services and wait times, and physical needs can be met in the moment.

Eleganza is the Health Care Foundation's biggest healthcare special event fundraiser. Over the course of three decades, Eleganza has raised millions of dollars to improve a variety of healthcare programs in our hospitals and health centres.



BRUNCH WITH THE BAGS



Brunch with the Bags™, presented by Fortis, returned to the Delta Hotel on May 15 for an afternoon of great entertainment, food, games and auction items in support of Women's Health.



GURNEY CUP

The 2022 Gurney Cup, presented by Johnson took place at The Wilds on June 16. The golf tournament raised \$105,000 in support of the Ambulatory Care and Emergency-Psychiatric Assessment Units.



ROW4HEART

Row4Heart took place on February 26 at a new, larger venue, Capital Hyundai. The cardiac fundraiser attracted a record number of teams, including heart transplant recipients, cardiac rehab patients, and the doctors and nurses on the Heart Team.

Event proceeds will expand access to cardiac diagnostics with “Virtual-First Cardiac Consultants,” so our cardiologists, cardiac surgeons and the Heart Team can instantly “see” patients in emergent or critical care settings, anywhere in the province, or even at home.

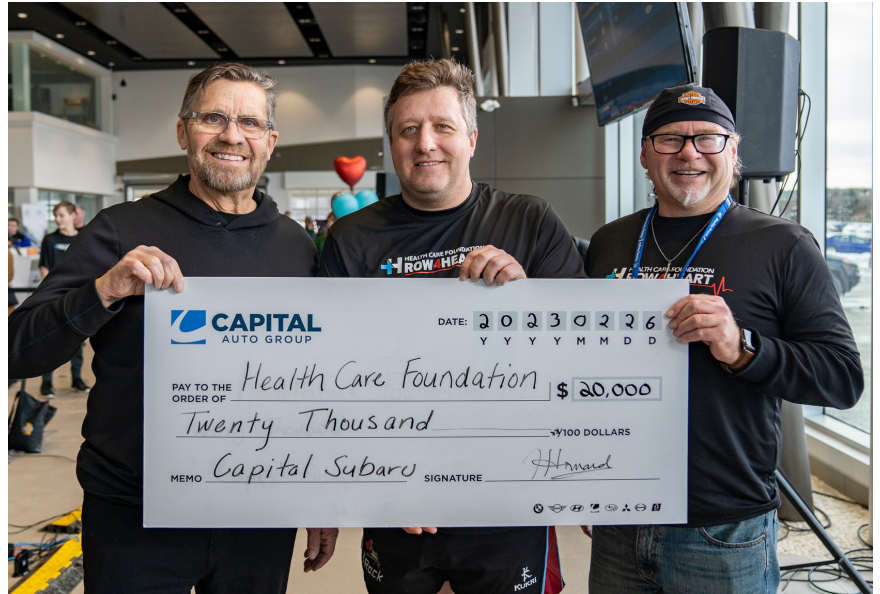

MILLER CENTRE CAR SHOW



Grateful patients and staff of the Miller Centre worked together to plan a classic car show on September 24.

Funds raised support the patient enrichment program, which allows rehabilitation patients to enjoy special events, outings and activities while away from home receiving life changing treatments.



BREAKFAST WITH SANTA



Presented by the Compass Group, the beloved “Breakfast with Santa” event returned for Eastern Health staff. Breakfasts were held at the Health Sciences Centre, St. Clare’s, Waterford Hospital, the Dr. L.A. Miller Centre and Pleasant View Towers.

Breakfast with Santa allows healthcare workers to enjoy a festive breakfast in support of seniors in long-term care, and raised over \$10,000. Breakfasts were sponsored by Johnson Insurance, Newfoundland Power, Capital Auto Group, Martin and Associates, RBC and Cahill.

TREE OF MEMORIES



Hosted by Karl Wells, the Tree of Memories broadcast honoured your loved ones while showcasing talented local musicians Peter Halley, Shelley Neville, Craig Sharpe, Bud Davidge and Friends, Damian Follett, D’Arcy Broderick and the 8 Track Trio. Tree of Memories was recorded at St. Mary’s Church, and broadcast on NTV three times over the holiday season. Funds raised from Tree of Memories support our Comfort in Care™ program, purchasing Christmas gifts for seniors in our long-term care homes.





**In support of your healthcare, our
2022 Health Care Foundation Home
Lottery was our most successful yet!**

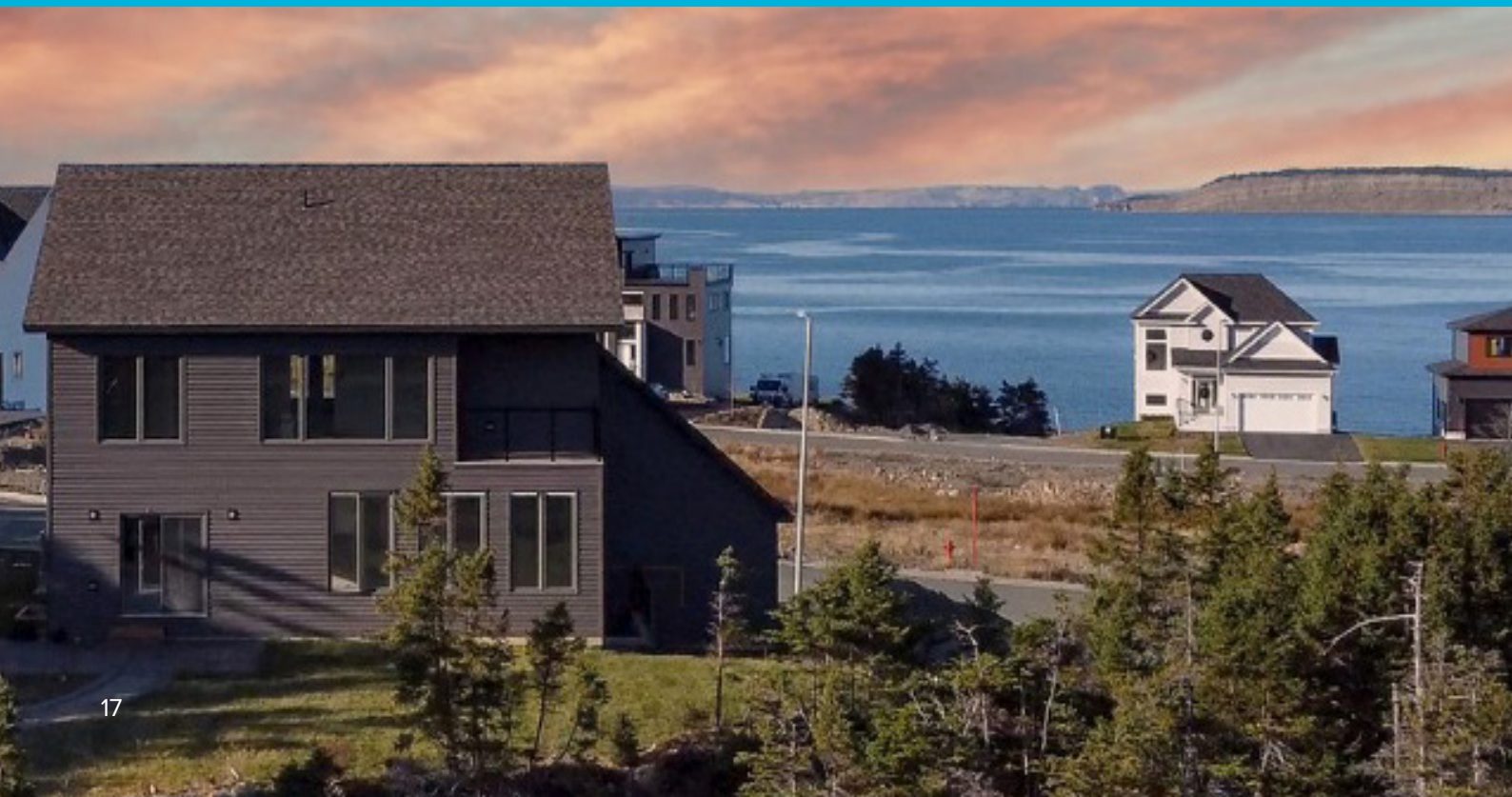



2022 HEALTH CARE FOUNDATION HOME LOTTERY

Our 2022 Health Care Foundation Home Lottery Show Home was a spectacular \$1.3 million-dollar ocean view grand prize, custom-built by MacIntyre Homes in Kingfisher Estates, CBS. The remarkable home featured over 4,000 square feet of living space, four bedrooms, a media room, home office and stunning views of the Atlantic Ocean and Bell Island from the front of the home, and the Manuels River from the back! The home was awarded fully furnished, professionally decorated, and came with \$50,000 cash. Over 950 other great prizes were up for grabs, including vehicles, holidays, cash and much more!

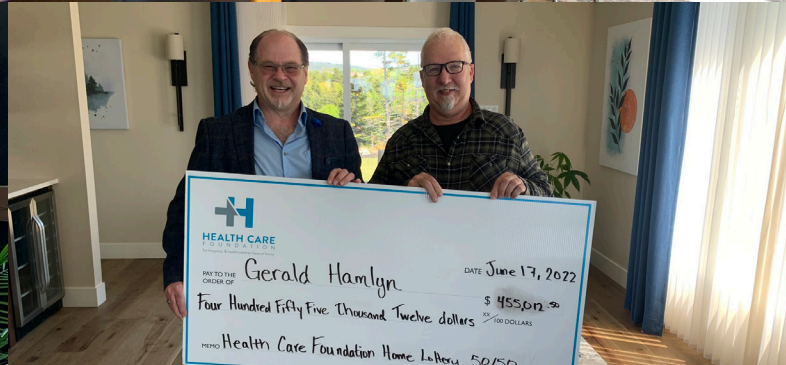
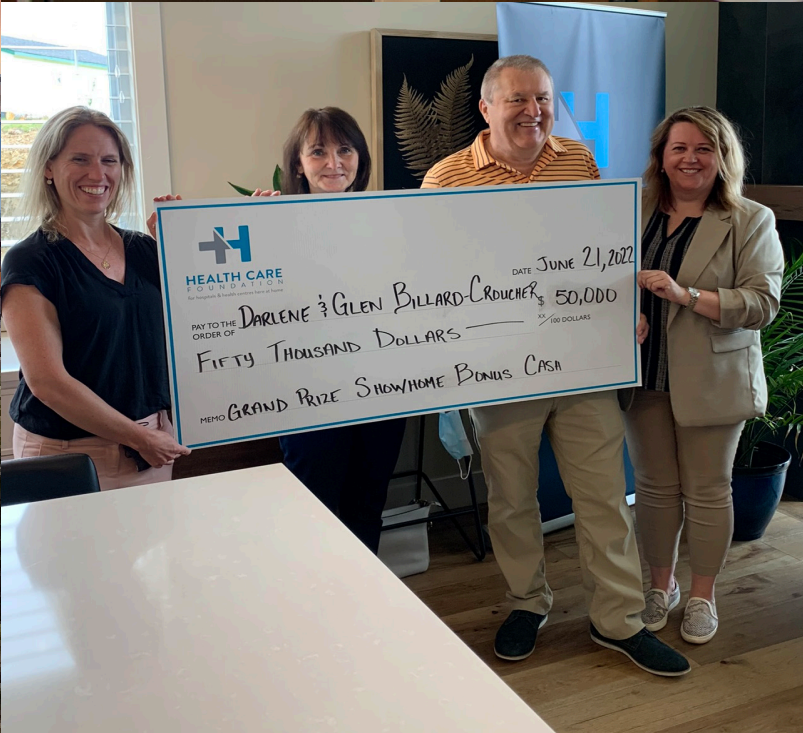

REVENUE BY SOURCE | 2022-2023

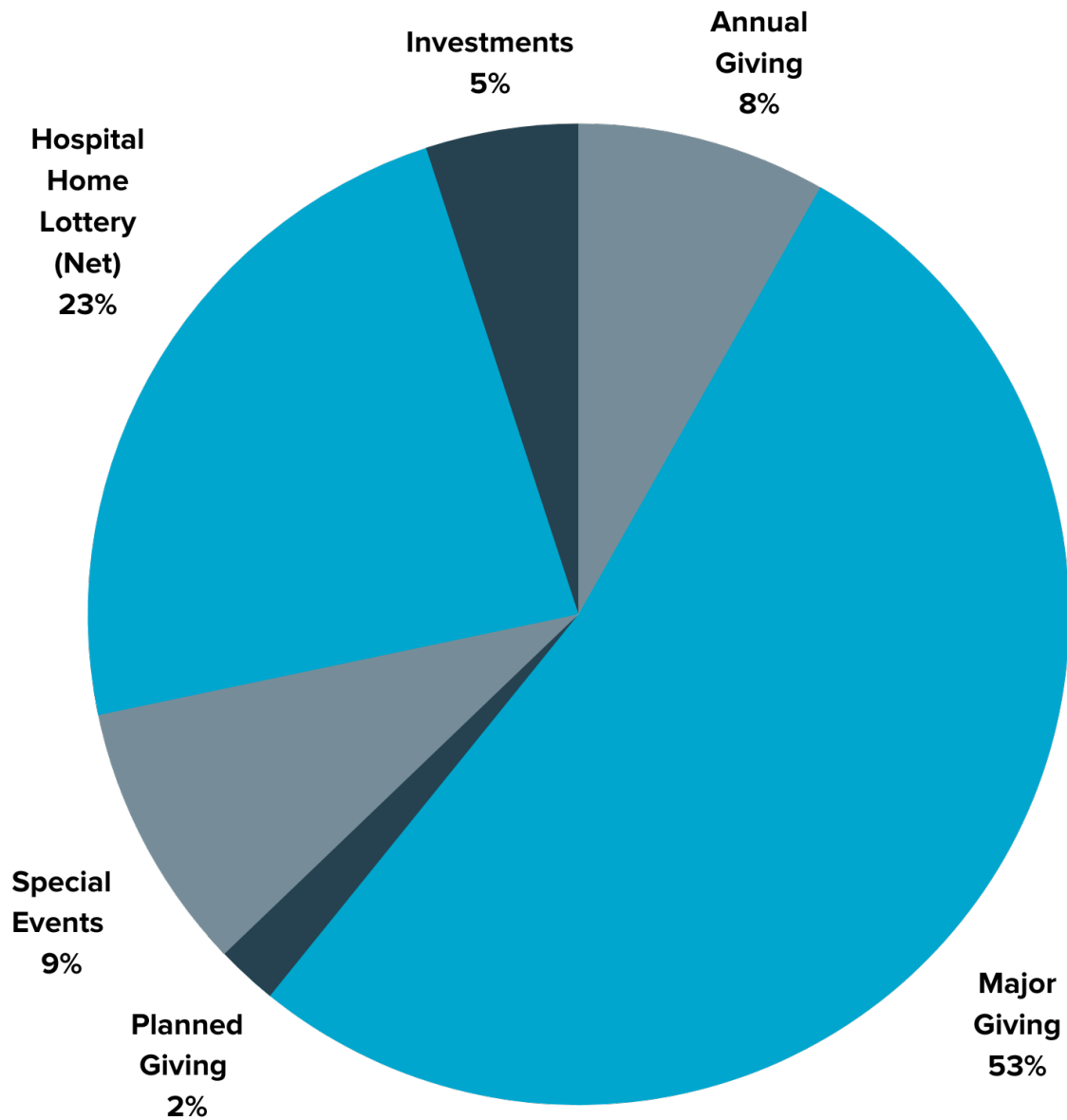

Total revenue for 2022-2023 fiscal year: **\$7,073,909**

FINANCIAL REVIEW | 2022-2023

Revenue	2023 Total	2022 Total
Annual Giving	580,021	642,178
Major Giving	3,722,568	1,260,367
Planned Giving	142,238	117,219
Special Events	627,741	326,288
Hospital Home Lottery (Net)	1,645,455	1,479,972
Government Subsidies	-	22,444
Investments	355,886	89,051
	\$7,073,909	\$3,937,519

Expenditures	2023 Total	2022 Total
Annual Giving	137,871	186,926
Major Giving	56,079	26,487
Planned Giving	-	-
Special Events	188,862	33,172
Salaries & Benefits	876,283	675,256
Administration	188,169	183,970
Communications	170,823	98,357
Amortization	17,181	17,844
	\$1,635,268	\$1,222,012

Excess Revenue after Expenditures before Grants to Eastern Health	\$5,438,641	\$2,715,507
--	--------------------	--------------------

Grants to Eastern Health	\$3,335,843	\$2,824,956
---------------------------------	--------------------	--------------------

Excess Revenue after Grants & Expenditures	\$2,102,798	(\$109,449)
---	--------------------	--------------------

LIFETIME PARTNERS IN HEALTHCARE

Guardian (\$10,000,000+)

TradesNL*

Philanthropist (\$1,000,000-9,999,999)

Sisters of Mercy*

Vale*

Johnson Insurance*

General Hospital Auxiliary*

St. Clare's Mercy Hospital Auxiliary*

BMO*

Friends of the Foundation*

Brothers Family Foundation*

King Family Foundation*

Pretty-Woodrow Foundation*

Visionary (\$500,000-999,999)

Sanofi Aventis*

Scotia Bank*

RBC*

CIBC*

Canon Medical Systems Canada Limited*

* Indicates cumulative giving

ANNUAL EVENT SPONSORS

Johnson Insurance • Fortis • Deloitte • Davies • PwC

PROGRAMS SPONSORS

Comfort in Care™: **Johnson Insurance • Estate of Gary Rowe**

Eastern Health Scholarship: **Estate of Gary Rowe**

Canadian Nursing Association Grants: **Johnson Insurance**

Moving Lives Forward Scholarships: **NAPE**

PLANNED GIVING

Leaving a gift in your will can be your personal and lasting legacy.

By improving the quality of healthcare for Newfoundlanders and Labradorians, you make a long-lasting and immediate mark on your community. You can bequest your gift to the area of care that matters most to you, or to the area of greatest need. Your gift can help purchase new equipment, patient comfort items, or fund staff education and medical research.

Your lawyer, accountant, financial planner, or insurance agent can help you determine what kind of planned gift would be best for you and your estate.

BOARD OF DIRECTORS



Ken Bennett
Chair



Jeannie French
Treasurer



David Jones
Secretary



John Allan
Director



Margaret Butt
Director



Robin Quinlan
Director



Collette Smith
Director



Dr. Sean Connors
Director

STAFF



Paul Snow
President and
CEO



Kelly Reid
Chief
Development
Officer



Allison Noseworthy
Chief Financial
Officer



Darlene Goodyear
Executive
Program
Officer



Gennette Martin
Development
Manager,
Annual Giving



Claire Carter
Communications
and Marketing
Manager



Rebecca Bowering
Special Events
Manager

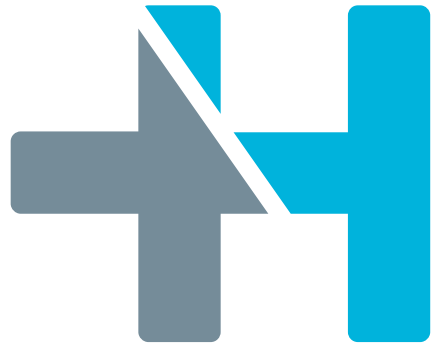

HEALTH CARE FOUNDATION

for hospitals & health centres here at home

**We Are Your
Health Care Foundation**

**We Take Action
So We Can Take Care
of Each Other**

Charitable Registration Number: 85699 2334 RR0001
Phone: (709) 777-5901 | **Email:** hcf@healthcarefoundation.ca |
Web: healthcarefoundation.ca

71 Goldstone Street, St. John's, NL A1B 5C3